

Instructions

CC251T



ALNOVA®

Millasur, SL.
Rúa Eduardo Pondal, nº 23 - Pol. Ind. Sigüeiro
15688 - Oroso - A Coruña 981 696465 www.millasur.com

EN



ANOVA wishes to congratulate you for choosing one of our products and guarantees the assistance and cooperation that has always distinguished our brand over time.

This machine is designed to last for many years and to be of great use if used in accordance with the instructions contained in the user manual. We therefore recommend that you read this instruction manual carefully and follow all our recommendations.

For more information or doubts, you can contact us through our web supports such as www.anovamaquinaria.com.

INFORMATION ABOUT THIS MANUAL

Please pay attention to the information provided in this manual and on the appliance for your safety and that of others.

- This manual contains instructions for use and maintenance.
- Take this manual with you when you go to work with the machine.
- The contents are correct at the time of printing.
- The rights to make changes at any time are reserved without affecting our legal responsibilities.
- This manual is considered an integral part of the product and must remain with it in case of loan or resale.
- Ask your dealer for a new manual in case of loss or damage.

READ THIS MANUAL CAREFULLY BEFORE USING THE MACHINE

To ensure that your machine provides the best results, please read the usage and safety regulations carefully before using it.

OTHER WARNINGS:

Incorrect use could cause damage to the machine or other objects. The adaptation of the machine to new technical requirements could cause differences between the content of this manual and the purchased product.

Read and follow all instructions in this manual. Failure to follow these instructions could result in serious personal injury.

CAVEAT:

For your own safety, please read this manual before attempting to operate your new unit. Failure to follow instructions may result in serious injury. Take a few moments to familiarize yourself with your mower before each use. Keep this manual in a safe place, so that the information is available at all times. If you hand over the equipment to another person, hand over these operating instructions and the safety regulations as well.

The equipment may only be used for the tasks for which it is designed. Any other use is considered a case of misuse. The user/operator, and not the manufacturer, will be liable for any damage or injury of any kind caused as a result of this.

The petrol lawn mower is intended for personal use, that is, for use in the home and garden environments.

Personal lawnmower use refers to an annual operating time generally not exceeding 50 hours, during which time the machine is primarily used for maintaining residential gardens and small-scale home/hobby gardens. Public facilities, sports halls and agricultural/forestry applications are excluded.

Please note that our equipment is not designed for use in commercial or industrial applications. Our guarantee will be void if the machine is used under the conditions mentioned above or for equivalent purposes. The operating instructions supplied by the manufacturer should be kept and consulted to ensure that the mower is used and maintained correctly. The instructions contain valuable information on operating conditions, maintenance and service conditions.

Important! Due to the high risk of bodily injury to the user, the mower cannot be used to trim bushes, hedges or large plants, to cut climbing vegetation, planted roofs or balcony-grown grass, to clean (vacuum) dirt and debris in walkways, or cut down trees. Also, the mower cannot be used as a power tiller to level high areas such as hills.

For safety reasons, the mower may not be used as a drive unit for other work tools or tool kits of any kind.

ALNOVA[®]

CONTENTS

SECTION 1 SYMBOLS MARKED ON THE PRODUCT

SECTION 2 GENERAL SAFETY RULES

SECTION 3 DESCRIPTION OF PARTS

SECTION 4 TECHNICAL INFORMATION

SECTION 5 ASSEMBLY

SECTION 6 "3 IN 1"

SECTION 7 OPERATING INSTRUCTIONS

SECTION 8 MAINTENANCE INSTRUCTIONS

SECTION 9 LUBRICATION

SECTION 10 CLEANING

SECTION 11 STORAGE INSTRUCTIONS

SECTION 12 TROUBLESHOOTING

SECTION 13 WARRANTY

SECTION 14 ENVIRONMENT

SECTION 15 EC-DECLARATION OF CONFORMITY

⚠ CAVEAT:

For your own safety, please read this manual before attempting to operate your new unit. Failure to follow instructions may result in serious personal injury. Take a few moments to familiarize yourself with your mower before each use.

1.SYMBOLS MARKED ON THE PRODUCT (On the back cover)



Figure A:

B.1 Read the Operator's Manual.

B.2 Keep bystanders away.

B.3 Pay more attention to the operator's hands and feet to avoid injury.

B.4 Fuel is flammable, keep fire away. Do not add fuel with the machine running.

B.5 Toxic vapors; Do not operate inside the house.

B.6 When mowing, please wear the goggles and earplugs to defend the operator.

B.7 When repairing, please take the spark plug, and then repair it according to the operational manual.

B.8 Caution: The engine is hot.



Figure B: Safety label found on mower: KEEP HANDS AND FEET OUT.

Caveat: Keep safety signs clear and visible on equipment. Replace safety signs if they are missing or illegible.

2. GENERAL SAFETY RULES

⚠ WARNING: CWhen using gasoline powered tools, basic safety precautions should always be followed, including the following to reduce the risk of serious personal injury and/or damage to the unit. Please read all of these instructions before operating this product and save these instructions for future reference.

⚠️ WARNING: This machine produces an electromagnetic field during its operation. This field can in some circumstances interfere with active or passive medical implants. To reduce the risk of serious injury or death, we recommend that individuals with medical implants consult their physician and the manufacturer of the medical implant before operating this machine.

Training

- Please read the instructions carefully. You should get used to the controls and the proper use of the equipment;
- Never allow children or persons unfamiliar with these instructions to use the mower. Local regulations may restrict the age of the operator;
- Never mow while people, especially children, or pets are nearby;
- Please note that the operator or user is responsible for accidents or hazards occurring to other people or their property.
- Operators must be properly trained in the use, adjustment and operation of the machine, including prohibited operations.

Preparation

- While mowing, always wear long shoes and pants. Do not use the equipment when barefoot or wearing open sandals.
- Thoroughly inspect the area where the equipment is to be used and remove all objects, such as stones, toys, sticks and wires, that can be thrown by the machine;
- **WARNING** - Gasoline is highly flammable.
 - Store fuel in containers specifically designed for this purpose.
 - Fill fuel only outdoors and do not smoke during the refilling process.
 - Add fuel before starting the engine. Never remove the fuel tank cap or add gasoline while the engine is running or when the engine is hot.
 - If gasoline is spilled, do not try to start the engine, but move the machine away from the spill area and avoid creating any source of ignition until the gasoline vapors have dissipated.
 - Replace all fuel tank and container caps securely;
- Replace faulty mufflers.
- Before use, always visually inspect to see that the blades, blade bolts and blade assembly are not worn or damaged. Replace worn or damaged blades and bolts in sets to preserve balance.

Operation

- Do not run the engine in a confined space where dangerous carbon monoxide fumes can collect.
- Warning! Do not use the mower when there is a risk of lightning.
- It is recommended to limit the duration of the operation, to minimize the risks of noise and vibrations.
- Be careful when using the mower on slopes and near drop-offs, ditches or embankments.
- Cut only in daylight or good artificial light.
- Avoid operating equipment on wet grass, when feasible.
- Always make sure you are sitting on slopes.
- Walk, never run.
- For wheeled rotary machines, mow across the face of slopes, never up and down.
- Use extreme caution when changing direction on slopes;
- Do not mow excessively steep slopes.
- Be very careful when backing up or pulling the mower toward you.
- Stop the blade if you have to tilt the mower for transport when crossing surfaces other than grass and when transporting the mower to and from the area to be mowed.

- Never operate mower with faulty guards, or without safety devices, eg deflectors and/or grass catchers.
- Caution: The mower should not be operated without the full grass guard or self-closing discharge opening guard.
- Do not change the motor governor settings or overload the motor.
- Do not modify or alter any sealed setting for motor speed control.
- The mower's safety features or systems must not be tampered with or disabled.
- Disengage all blades and drive clutches before starting engine.
- Start the engine carefully according to instructions and with feet well away from the blades.
- Do not tilt the mower when starting the engine.
- Do not start the engine when it is stopped in front of the discharge chute.
- Do not put your hands or feet near or under rotating parts. Stay clear of discharge opening at all times.
- Never pick up or carry a lawnmower while the engine is running.
- Stop the engine and disconnect the spark plug wire, make sure all moving parts have stopped completely, and if there is a key, remove the key in the following cases:
 - Before cleaning obstructions or unblocking the duct.
 - Before checking, cleaning or working on the mower;
 - After hitting a foreign object. Inspect mower for damage and make repairs before restarting and operating mower.
 - If the mower starts to vibrate abnormally (check immediately).
- Stop the engine and disconnect the spark plug wire, make sure all moving parts have stopped completely, and if there is a key, remove the key:
 - Whenever you leave the lawn mower.
 - Before adding fuel.
- Reduce the throttle setting during engine shutdown and, if the engine is equipped with a shutoff valve, shut off fuel at the end of mowing.

Maintenance and storage

- Keep all nuts, bolts, and screws tight to ensure the equipment is in safe working condition.
- Never store equipment with gasoline in the tank inside a building where gases can reach a flame or spark;
- Let the motor cool down before storing it in any enclosure; clean and maintain the mower before storing it.
- To reduce the risk of fire, keep the engine, muffler, battery compartment, and fuel tank free of grass, leaves, or excessive grease;
- Frequently check the grass catcher for wear and tear.
- Replace worn or damaged parts for safety.
- If the fuel tank has to be drained, this must be done outdoors.
- Improper maintenance, use of nonconforming replacement components, or removal or modification of safety components can damage the mower and seriously injure operators.
 - Use only blades and replacement parts recommended by the manufacturer. The use of non-original parts can damage the machine and harm operators. Keep the mower in good working condition.

 **CAUTION:** Do not touch the rotating blade.

 **CAUTION:** Refuel in a well-ventilated area with the engine stopped.

3. DESCRIPTION OF THE PARTS

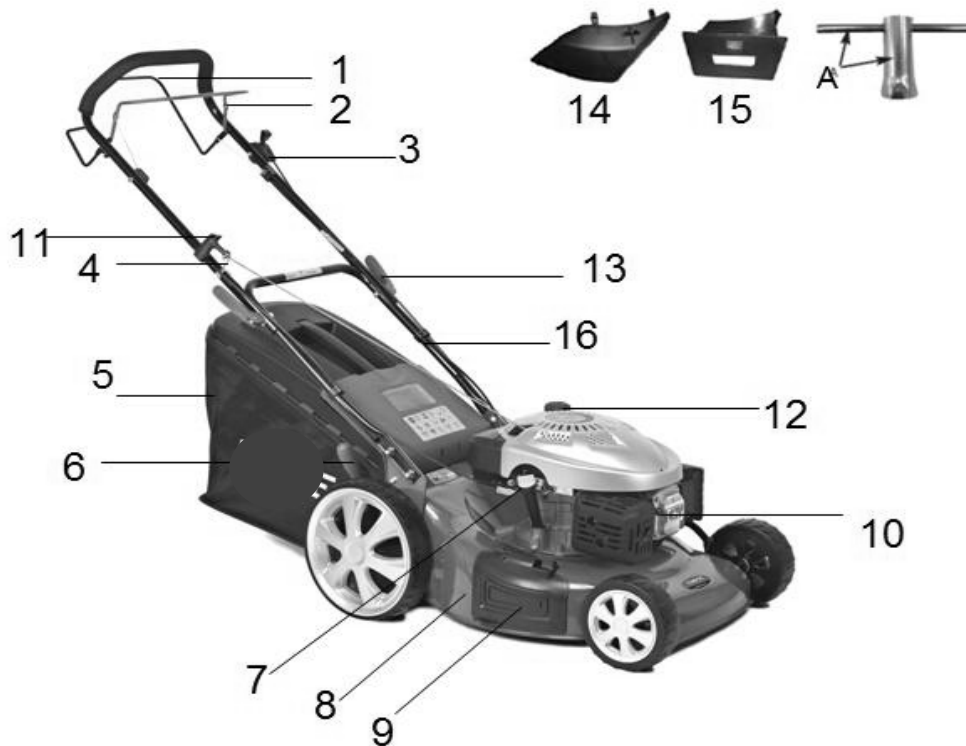

Figure 1

- | | | |
|-------------------|---------------------------|----------------------------|
| 1. control handle | 2. Brake control handle | 3. Choke throttle lever |
| 4. Rope guide | 5. Grass catcher | 6. Height adjustment lever |
| 7. Oil cap | 8. Cover | 9. Side flap |
| 10. Spark plug | eleven.boot handle | 12. Fuel cap |
| 13. Lock lever | 14.Side discharge channel | 15. Quilting Wedge |
- It includes:** Spark plug wrench

ALNOVA[®]

4. TECHNICAL INFORMATION

Model	CC251T
Type of motor	MA173
self propelled	Yes
engine displacement	173 cm ³
Rated Power	3.6kW
blade width	510mm
full power speed	2700/min
Fuel tank capacity	2.0L
Grass catcher capacity	60L
Net weight	37.3kg
height adjustment	25-75mm, 10 settings

Guaranteed sound pressure level at operator position (According to EN ISO 5395-1 Annex F & EN ISO 5395-2, EN ISO 4871)	84.3dB(A) (K=3dB(A))
Measured sound power level	93.9dB(A) K=2.01dB(A)
Guaranteed sound power level (According to 2000/14/EC)	98dB(A)
Vibration (According to EN ISO 5395-1 Annex G & EN ISO 5395-2)	4,489m/s ² K=1.5m/s ²

5. ASSEMBLY

5.1 FOLDING HANDLE

1. Fix the lower handlebar on the body of the unit with a suitable wrench. (Fig.2A)
- two. Lift the two lock levers to release the upper handlebar for folding. (Fig.2B)
3. Push the lock lever to lock the handlebar in the operating position. (Fig.2B)
- Four. Adjust the tension by turning the lock nut with a suitable wrench.. (Fig.2B)
5. Put the clamp in the indicated position and then connect the cable. (Fig.2C)

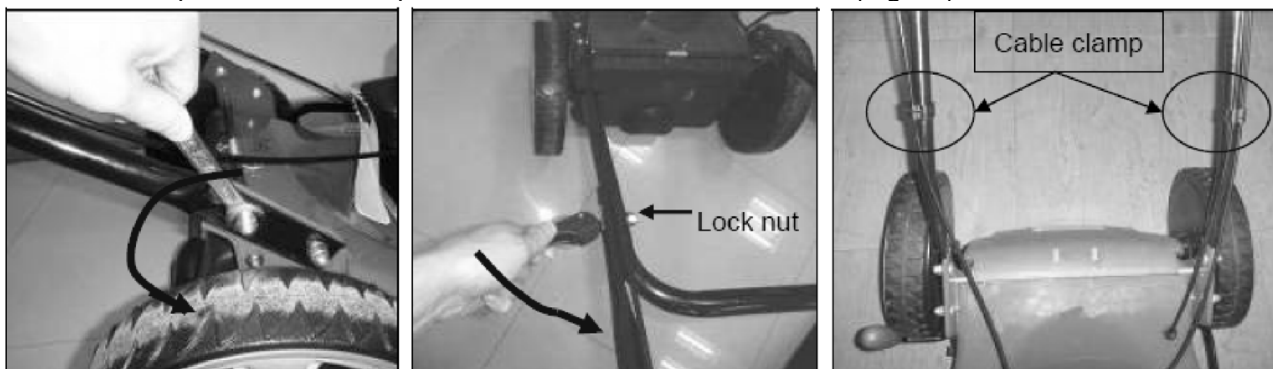

Fig. 2A Fig. 2B Fig. 2C

5.2 ASSEMBLING AND DISASSEMBLING THE GRASS CATCHER

1. Assembly: Raise rear deck and grass catcher hitch at rear of mower.
2. To remove: Grasp and lift rear cover, remove grass catcher.



Fig. 3A Fig. 3B Fig. 3C

5.3 STARTER HANDLE

Move the engine starter handle to the rope guide.



Fig.4A Fig.4B

5.4 CUTTING HEIGHT

Apply outward pressure to disengage zipper lever. Move the lever forward or backward to adjust the height. (Fig.5)



Fig.5

6. "3 IN 1"

These mowers can be adapted from their normal function, based on the purpose of the application:

From rear discharge mower to:

- 1.- Collection mower or its equivalent.
- 2.- Side discharge mower.

What is compost?

When you want to fertilize, the grass is cut in one step, then finely cut and spread again as natural fertilizer.

Tips for compost mowing:

- Cut regularly by max.2cm from 6cm to 4cm tall grass.
- Use a sharp blade - Do not cut wet grass.
- Set to maximum engine speed.
- Just move at work pace.
- Regularly clean the mulch wedge, the inside of the housing and the mowing blade.

Start of operation

ONE: Adaptation for compost cutter

⚠ WARNING: only in case of stopped motor or static cut.

1. Raise the rear cover and remove the grass catcher.
- two. Push the quilting wedge into the cover. Lock the quilting wedge with the button in the opening of the cover. (Fig.6A/Fig.6B)
3. Replace the rear cover.

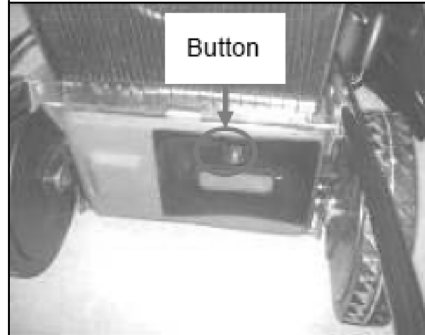

Fig.6A Fig.6B

TWO: Reprogramming for side discharge mowing

⚠ WARNING: only when the motor and the cut are static.

1. Raise the rear cover and remove the grass catcher.
2. Mount the mulching wedge.
3. Raise side flap for side discharge. (Fig.7A)
4. Mount the side discharge discharge guide to the side flap support pin. (Figure7B)
5. Lower side flap, flap rests in discharge chute.(Fig. 7C)



Fig.7A Fig.7B Fig.7C

THREE: Cut with the grass catcher

To mow with the grass catcher, remove the spreader wedge and side discharge chute and mount the grass catcher.

1. Extraction of the subscriber wedge:

- Raise the rear cover and remove the spreader wedge.

2. Side Discharge Chute Extraction for Side Discharge:

- Lift the side flap and remove the side discharge chute.

-The side flap automatically closes the discharge opening in the housing by spring force.

-Regularly clean the side flap and the discharge opening forms from the rest of grass and adhering dirt.

3. Assembling the grass catcher:

-To fit: Raise the rear deck and hook the grass catcher onto the rear of the mower.

-To remove: Grasp and lift rear cover, remove grass catcher.

⚠️ WARNING: Carry out the adjustment operations with the motor and cutter stopped.

7. OPERATING INSTRUCTIONS

Service the engine with gasoline and oil as instructed in the manual that is packed with your mower. Please read the instructions carefully.

⚠️ WARNING: Gasoline is highly flammable.

Store fuel in containers specifically designed for this purpose.

Refuel only outdoors, before starting the engine and do not smoke while refueling or handling fuel.

Never remove the fuel tank cap or add gasoline while the engine is running or when the engine is hot.

If gasoline is spilled, do not attempt to start the engine, move the machine away from the spill area and avoid creating any source of ignition until the gasoline vapors have dissipated.

Replace all fuel tanks and container caps securely.

Before tipping mower to maintain blade or drain oil, drain fuel from tank.

⚠️ WARNING: Never fill the fuel tank indoors, with the engine running, or until the engine has cooled for at least 15 minutes after running.

7.1 TO START THE MOTOR AND ENGAGE THE CUT

1. Unit is equipped with a socket on the spark plug end, make sure the metal loop on the end of the spark plug wire (inside the socket) is secured over the metal tip of the spark plug.

2. When starting the cold engine, turn the throttle lever to the position  (Fig.9A)

When warming up the engine while running, turn the throttle lever to the position  (Fig.9A)

3. Stand behind the unit, grasp the brake control handle and hold it against the upper handle as shown in Figure 9B.

4. Hold the starter handle as shown in Fig.9B and lift it up quickly. Slowly return it to the rope guide bolt after the engine starts.

Release brake control handle to stop motor and blade.

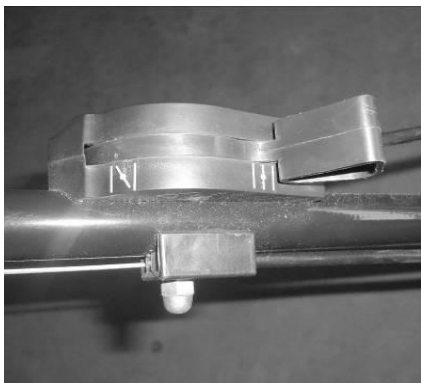

Fig.9A Fig.9B

⚠️ Start the engine carefully according to the instructions and with your feet well away from the blade.

⚠️ Do not tilt mower when starting engine. Start the mower on a level surface free of tall grass or obstacles.

⚠️ Keep hands and feet away from rotating parts. Do not start the engine when it is standing in front of the discharge opening.

7.2 OPERATING PROCEDURES

During operation, hold the brake handle firmly with both hands.

⚠️ Note: During operation, when the brake handle is released, the engine will stop, thereby stopping mower operation.

⚠️ WARNING: To prevent any inadvertent starting of the mower, the mower is equipped with an engine brake which must be removed before the engine can be started. When the engine control lever is released, it should return to its home position, at which point the engine automatically shuts off.

Note: Engine brake (brake handle): Use the lever to stop the engine. Releasing the lever will automatically stop the motor and blade. To cut, keep the lever in the working position. Before you start cutting, check the start/stop lever several times to make sure it is working properly. Make sure the tension cable can be operated smoothly (i.e. not caught or twisted in any way)

7.3 TO STOP THE ENGINE

CAUTION: The blade continues to rotate for a few seconds after the engine is turned off.

1. Release brake control handle to stop motor and blade. (Fig.9)
2. Disconnect and ground spark plug wire as instructed in engine manual to prevent accidental starting while equipment is unattended.

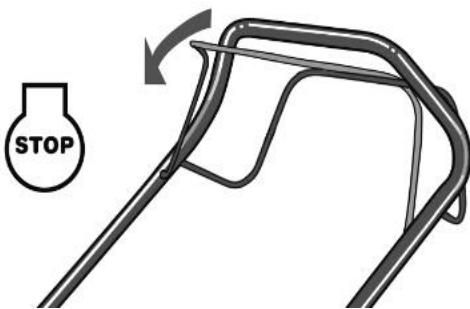

Fig 9

7.4 CONNECTION FOR AUTOMATIC MOVEMENT

Grasp the self-driving control handle, the mower will move forward automatically with about 3 km/h (Fig. 10), release the self-driving handle, the mower will stop moving.

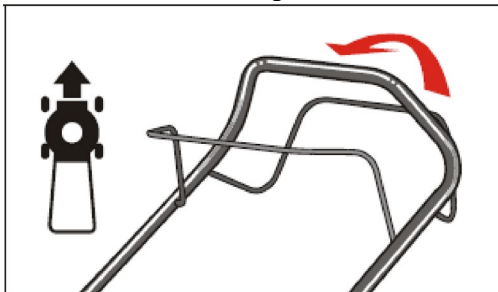

Fig.10

7.5 FOR THE BEST RESULTS IN MOWING

Clean up debris on the lawn. Make sure the lawn is clear of stones, sticks, wire, or other foreign objects that could be accidentally thrown by the mower in any direction and cause serious personal injury to the operator and others, as well as damage to property and surrounding objects. Do not cut wet grass. For effective mowing do not cut wet grass as it tends to stick to the underside of the deck preventing proper cutting of grass clippings. Cut no more than 1/3 of the length of the grass. The recommended cut for mowing is 1/3 of the length of the grass. The ground speed will need to be adjusted so that the clippings can be evenly dispersed on the lawn. For especially heavy cutting in thick grass it may be necessary to use one of the slower speeds to get a clean, well-cut cut. When cutting long grass you may have to cut the grass in two passes, lowering the blade another 1/3 of the length for the second cut and perhaps cutting in a different pattern than was used the first time. Overlapping the cut at each pass will also help clean up any stray clippings left on the lawn. The mower should always be operated at full throttle to get the best cut and allow it to do the most efficient job of mowing. Clean underside of cover. Be sure to clean the bottom of the cutting deck after each use to prevent a buildup of grass, which prevents proper padding. Leaf cutting. Leaf mowing

can also be beneficial for your lawn. When you mow the leaves, make sure they are dry and not too thick on the lawn. Don't wait for all the leaves to be off the trees before cutting.

⚠️ WARNING: If you hit a foreign object, stop the engine. Remove the spark plug wire, thoroughly inspect the mower for any damage, and repair the damage before restarting and operating. Extensive mower vibration during operation is an indication of damage. The unit must be promptly inspected and repaired.

7.6 GRASS COLLECTOR

There is a window on the rear deck. You can see the condition of the grass catcher through the window. If the catcher is full of grass, it will empty and clean the bag, make sure it is clean and make sure its mesh is vented. Figure 11

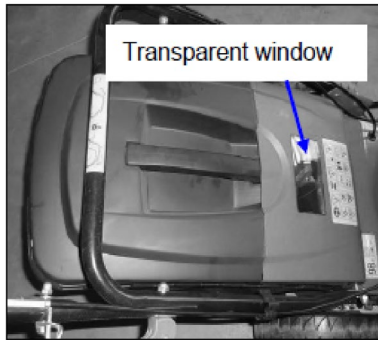

Fig.11

7.7 COVER

The underside of the mower deck should be cleaned after each use to prevent the buildup of grass clippings, leaves, dirt, or other debris. If these residues are allowed to accumulate, they will invite rust and corrosion, and may prevent proper mulching. The deck can be cleaned by tilting the mower and scraping with a suitable tool (make sure the spark plug wire is disconnected).

7.8 INSTRUCTIONS FOR HEIGHT ADJUSTMENT

⚠️ CAUTION: Do not at any time make any adjustments to the mower without first stopping the engine and disconnecting the spark plug wire.

⚠️ CAUTION: Before changing cutting height, stop mower and disconnect spark plug wire.

Your mower is equipped with a center height adjustment lever that offers 10 positions.(Fig.12)

Height (blade to ground) can be adjusted from 25mm to 75mm (10 height positions).

1. Stop the mower and disconnect the spark plug wire before changing the mower's cutting height.
2. The central height adjustment lever offers you 10 different height positions.

To change the height of the rear wheel, squeeze the adjustment lever towards the wheel, moving it up or down to the selected height.



Fig.12

8. MAINTENANCE INSTRUCTIONS

SPARK PLUG

Use only an original replacement spark plug. For best results, replace the spark plug every 100 hours of use.

BRAKE PADS

Check and/or replace engine brake pads at service agent regularly, only original parts can be used as replacement.

9. LUBRICATION INSTRUCTIONS

⚠ CAUTION: DISCONNECT SPARK PLUG BEFORE REPAIRING.

1. **WHEELS** -Lubricate the ball bearings in each wheel at least once a season with a light oil.
2. **ENGINE** -Follow the engine manual for lubrication instructions.

10. CLEANING

⚠ CAUTION: Do not hose down the engine. Water can damage the engine or contaminate the fuel system.

1. Clean the cover with a dry cloth.
2. Hose off under deck by tilting mower so spark plug is on top.

10.1 ENGINE AIR CLEANING

⚠ CAUTION: Do not allow dirt or dust to clog the air filter. The foam element in the engine air cleaner should be serviced (cleaned) after 25 hours of normal mowing. The filter must be cleaned regularly if the mower is used in dry and dusty conditions.

TO CLEAN ENGINE AIR FILTER

1. Press down on the two tabs at the top of the filter cover. (Fig.13A)
2. Remove filter cover.
3. Wash the filter element with soapy water. **DO NOT USE GASOLINE!**
4. Blow out the filter element with air.
5. Put a few drops of SAE30 oil on the foam filter and squeeze vigorously to remove excess.
6. Reinstall filter.

⚠ NOTE: Replace the filter if it is worn, cracked, damaged or cannot be cleaned.

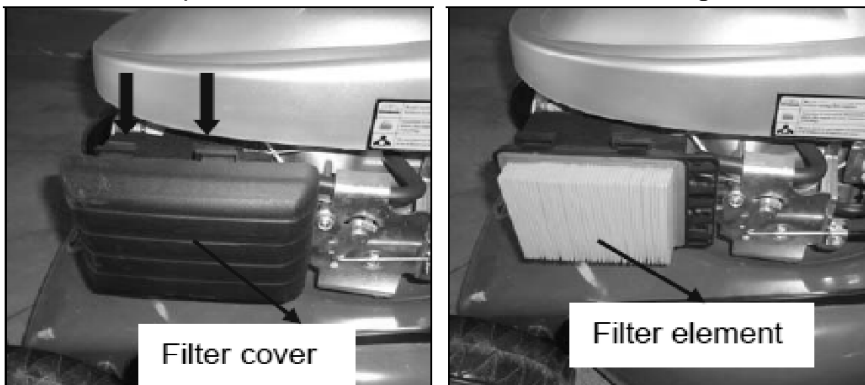

Fig.13A Fig.13B

10.2 CUTTING BLADE

⚠ CAUTION: Be sure to disconnect and ground the spark plug wire before working on the cutting blade to prevent accidental starting of the engine. Protect your hands by wearing thick gloves or a rag to grip the cutting blades. As specified in the attached engine manual. Remove the hex bolt and washer holding the blade and blade adapter to the engine crankshaft. Remove the blade and adapter from the crankshaft.

⚠ WARNING: Periodically inspect the blade adapter for cracks, especially if it hits a foreign object. Replace when necessary.

For best results, the blade must be sharp. The blade can be resharpened by removing it and grinding or filing the cutting edge keeping it as close to the original bevel as possible. It is extremely important that each cutting edge receives an equal amount of grinding to avoid an unbalanced blade. Improper blade balance will cause excessive vibration which will cause engine and mower damage. Be sure to carefully balance the blade after sharpening. The blade can be tested for balance by balancing on a round shaft screwdriver. Remove metal from heavy side until evenly balanced.

Before reassembling the blade and blade adapter to the unit, lubricate the engine crankshaft and the inner surface of the blade adapter with light oil. Insert the key into the blade adapter and install the blade adapter to the engine crankshaft, push the washer into the blade adapter and install the blade, see figure 14. Position the blade with the part number facing out of the adapter. You need to line up the washer over the blade and insert the hex bolt. Tighten the hex bolt as indicated below:

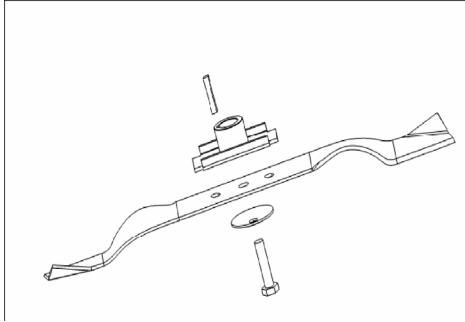

Fig.14

10.3 BLADE MOUNTING TORQUE

Use a 40Nm-50Nm center bolt, to ensure safe operation of your unit. ALL nuts and bolts should be checked periodically for proper tightness.

After prolonged use, especially in sandy soil conditions, the sheet wears down and loses some of its original shape. The cutting efficiency will be reduced and the blade will be replaced. Replace only with an approved factory replacement blade. Possible damage resulting from the unbalanced condition of the blade is not the responsibility of the manufacturer.

When changing the blade, you must use one of the original type marked on the blade (DAYE 263001330) (to order the blade, please contact your local dealer or call our company, see front cover).

⚠ WARNING: Do not touch the moving blade.

10.4 ENGINE

Consult the engine manual for its maintenance instructions.

Maintain engine oil as directed in the manual that came with your unit. Read and follow the instructions carefully.

Clean the air filter according to the instructions in the engine manual under normal conditions.

Clean every few hours under extremely dusty conditions. Engine malfunction and flooding usually indicate that the air filter needs to be repaired.

To repair the air filter, refer to the engine manual that came with your unit.

The spark plug should be cleaned and the gap reset once a season. Spark plug replacement is recommended at the beginning of each mowing season; Check the engine manual for the correct plug type and spacing specifications.

Clean the motor regularly with a cloth or brush. Keep the cooling system (blower housing area) clean to allow proper air circulation which is essential for engine performance and life. Be sure to remove all grass, dirt, and combustible debris from the muffler area.

11. STORAGE INSTRUCTIONS

Steps to follow to prepare the mower for storage.

1. Empty the tank after the last mowing of the season.
 - A) Empty the fuel tank with a suction pump

⚠ CAUTION! Do not drain gasoline in closed spaces, near a fireplace, etc. Do not smoke! Gasoline vapors can cause explosion or fire.

B) Start the engine and let it run until all the gasoline has been used up.

C) Remove the spark plug. Use an oil container to fill approx. 20 ml of oil in the combustion chamber. Run the starter motor to evenly distribute the oil in the combustion chamber. Replace spark plug.

2. Carefully clean and oil mower as described under "Lubrication" above.

3. Lightly oil the cutter to prevent corrosion.

4. Store the mower in a dry, clean and frost-protected place, out of reach of unauthorized persons.

⚠ CAUTION! Engine must be completely cool before mower is stored.

⚠ NOTE:- When storing any type of power equipment in a storage shed without ventilation or material,
 - Equipment anti-corrosion precautions should be taken. Using a light oil or silicone, coat the equipment, especially the cables and all moving parts.

- Be careful not to bend the cables.

- If the starter cable becomes disconnected from the cable guide, disconnect and ground the spark plug cable. Squeeze the blade control handle and pull the starter cable slowly. Slide the starter cable onto the cable guide pin on the handle.

Transportation

Shut off the engine and let the engine cool down. Next, disconnect the spark plug wire and drain the fuel tank according to the instructions in the engine manual. Make sure not to bend or damage the mower when pushing it over obstacles.

12. TROUBLESHOOTING

ISSUE	CAUSE OF THE PROBLEM	CORRECTIVE ACTION
The motor does not start.	The throttle choke is not in the correct position for the prevailing conditions.	Move primer to correct position.
	The fuel tank is empty.	Fill tank with fuel: See ENGINE OWNER'S MANUAL.
	The air filter element is dirty.	Clean air cleaner element: Refer to ENGINE OWNER'S MANUAL.
	Loose spark plug.	Tighten spark plug: refer to ENGINE OWNER'S MANUAL
	Spark plug wire is loose or disconnected from plug.	Install the spark plug wire on the spark plug.
	Spark plug gap is incorrect.	Electrode gap adjustment: refer to ENGINE OWNER'S MANUAL
	The spark plug is defective.	Install a new properly capped spark plug - refer to ENGINE OWNER'S MANUAL
	The carburetor is flooded with fuel.	Remove the air cleaner element and pull the starter cable continuously until the carburetor comes off and install the air cleaner element.
Defective ignition module.	Contact your service representative.	
Engine starts hard or loses power.	Dirt, water or dirty fuel tank.	Drain fuel and clean tank. Fill the tank with clean, fresh fuel.
	The vent hole in the fuel tank cap is plugged.	Clean or replace fuel tank cap.
	The air filter is dirty	Clean the air filter.

The engine runs irregularly.	faulty spark plug	Install a new properly capped plug - see ENGINE OWNER'S MANUAL
	Spark plug gap is incorrect.	Electrode gap adjustment: refer to ENGINE OWNER'S MANUAL
	The air filter is dirty	Clean air cleaner element - refer to ENGINE OWNER'S MANUAL
The engine runs poorly.	The air filter element is dirty.	Clean air cleaner element - refer to ENGINE OWNER'S MANUAL
	The air slots on the motor cover are blocked.	Remove debris from slots.
	Blocked cooling fins and air passages under engine fan shroud.	Remove debris from cooling fins and air passages.
Engine jumps to high speed.	The gap between the spark plug electrodes is too narrow.	Electrode gap adjustment: refer to ENGINE OWNER'S MANUAL
The engine overheats.	Cooling air flow is restricted.	Remove debris from cover slots, blower housing, air ducts
	Wrong plug.	For 124T engine: Install RJ19LMC spark plug and cooling fins on engine. For DG600 engine: Install F7RTC spark plug and cooling fins on engine.
The mower vibrates abnormally.	The cutting assembly is loose.	Adjust the blade.
	The cutting assembly is out of balance.	Balance the blade.

13.WARRANTY

This product is guaranteed in accordance with legal regulations for a period of 12 months from the date of purchase by the first user.

This warranty covers all material or production faults, does not include defects in normal wear parts, such as bearings, brushes, cables, plugs or accessories such as drills, bits, saw blades, etc., damage or defects resulting from abuse , Accidents or alterations; Not even transportation costs.

We reserve the right to reject any claim where the purchase cannot be verified or where it is clear that the product was not properly maintained. (Clean ventilation slots, regularly maintained carbon brushes...)

Your purchase receipt should be kept as proof of purchase date.

Your non-disassembled tool must be returned to your dealer in a clean, acceptable condition, in its original molded case, if applicable to the unit, accompanied by your proof of purchase.

14.ENVIRONMENT

If your machine needs to be replaced after extended use, please do not put it in household waste, dispose of it in an environmentally safe manner.



15. EC DECLARATION OF CONFORMITY



CE

ANOVA

DISTRIBUTION COMPANY

MILLASUR, SL
RUA EDUARDO PONDAL, Nº 23 PISIGÜEIRO
15688 OROSO - A CORUÑA
SPAIN

EC DECLARATION OF CONFORMITY

In compliance with the different CE directives, it is hereby confirmed that, due to its design and construction, and according to the CE mark printed by the manufacturer on it, the machine identified in this document complies with the relevant and fundamental health and safety requirements. of the aforementioned EC directives. This declaration validates the product to display the CE symbol.

In the event that the machine is modified and this modification is not approved by the manufacturer and communicated to the distributor, this declaration will lose its value and validity.

Machine name: LAWNMOWER

Model: **CC251T**

Recognized and approved standard to which it conforms:

Directive 2006/42/EC / Directive 2014/30/EU

Tested according to:

EN ISO 5395-1:2013 / EN ISO 53-5-2:2013

ISO 14982:2009

Testreport: 708880741301-10 / 704030802917-06

Company seal

millasur
Rúa Eduardo Pondal, nº 23
Pol. Ind. Sigüeiro - 15688 Oroso - A Coruña
Tlf. 981 696465 / Fax. 981 690861

07/01/2016